



Kia Rio, 1,0 T-GDI 120 Mild-Hybrid EX, ym. 2020

Engine: 998cm³, 3 cylinder, turbo, 48v lithium-ion battery

Gearbox: Dual clutch automatic 7 gears

Top power: 88kw (120hp) /6000rpm

Top torque: 200nm /2000 - 3500rpm

Weight: 1155 - 1253 kg

Fuel consumption: 5,4 l/100km

WLTP CO² Emissions: 123g/km

Summer tyres: Michelin

Winter tyres: Continental non-studded

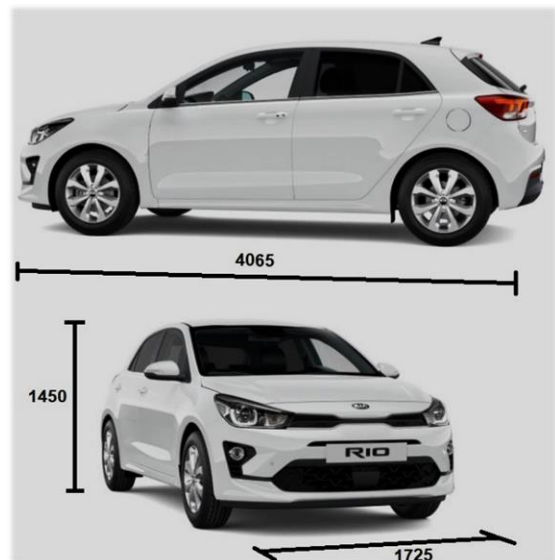

CAR CONTROLLERS

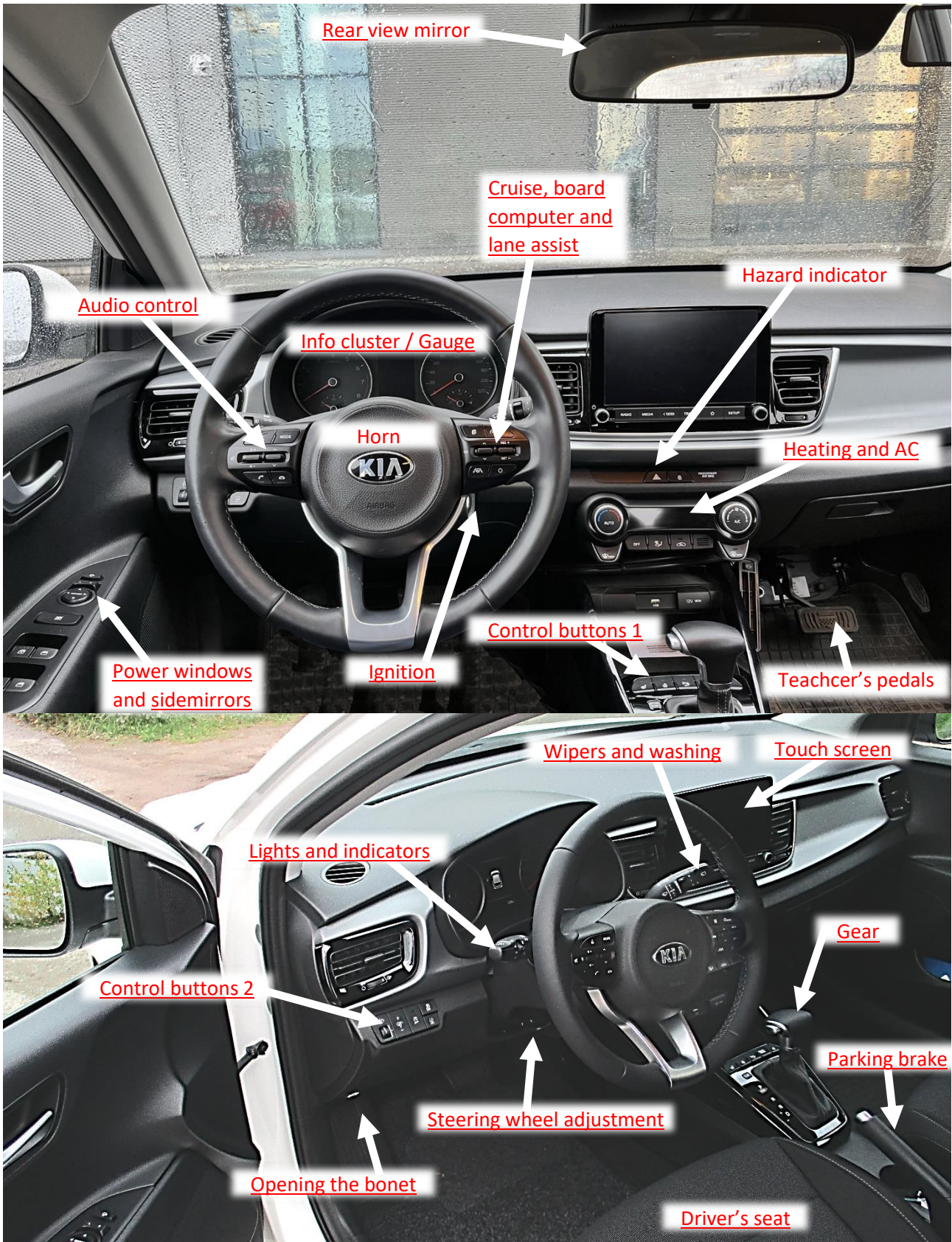

OPENING AND LOCKING DOORS



By pressing button (A) on the key, you can open up the key. The doors are locked with button (B) and unlocked with button (C). The trunk can be unlocked with the button (D).



Lock button on dashboard

STARTING THE ENGINE

You can open the key by pressing the chrome button (A) on the key. Place the key in the ignition lock in the straight position. Avoid using excessive force. Before starting the engine, make sure the gear is in the P position. In this car model, you don't need to press the brake when starting. Turn the ignition key clockwise to the START position until the engine starts. After that, let go of the key. When you turn off the engine, turn the ignition key to the LOCK position and carefully pull the key out of the ignition lock.



(LOCK) You can only remove the key in the lock position. If you turn the car's steering wheel without the key, the steering will lock. You can unlock the steering by turning the steering wheel and the key at the same time.

(ACC) The car's electronic accessories are available to use and the steering wheel lock is released.

(ON) It is possible to check the warning lights before starting the engine. The ignition key returns to this position after starting.

(START) To start the car, turn the ignition key to the START position. With the engine running, release your grip on the key.

HOW TO START:

1. Gear on P -position
2. Turn the key to START
3. When the engine running, release the key

GEAR SELECTOR

The gear selector is located in the center console of the car. Only change gears when the car is stationary. The selected gear is displayed next to the gear selector in yellow, but you can best see the selected gear at the top of the instrument panel info screen.



P = Park gear

R = Reverse

N = Neutral

D = Drive

+/- = Manual shifting

Selected gear

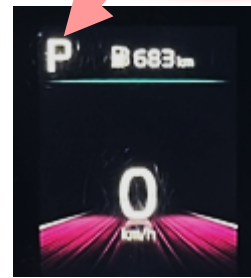

PARKING BRAKE

The parking brake is located in the center console. To release the parking brake, gently lift the lever a few millimeters upwards. Now push the release button in and lower the lever. When you park the car and put the parking brake on again, lift up the parking brake lever without pressing the release button.

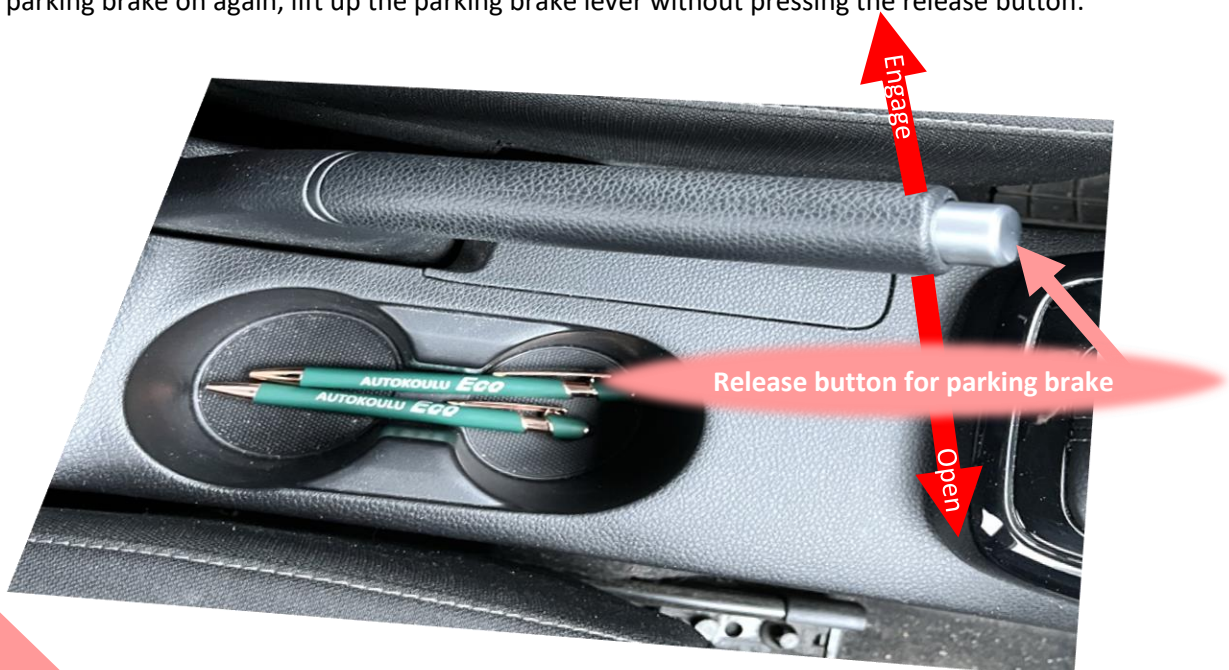

SEAT ADJUSTMENT

First, adjust the height of the seat so that your gaze is at the height of the middle of the windshield. By lifting the lever (A) from the front edge upwards, the seat moves upwards, and by pressing downwards, the seat moves downwards. When you adjust the seat height, the distance also changes slightly. Next, adjust the seat distance. Lift the lever (B) up to unlock the adjustment and then move the seat to the appropriate distance. You can adjust the inclination of the backrest by opening the lever (C) upwards and moving the seat backrest.



Adjust the upper edge of the headrest to the height of your head. If you want to adjust the headrest lower, press the headrest locking button in and then adjust the headrest downwards with the other hand. You can raise the headrest upwards without pressing the locking button.

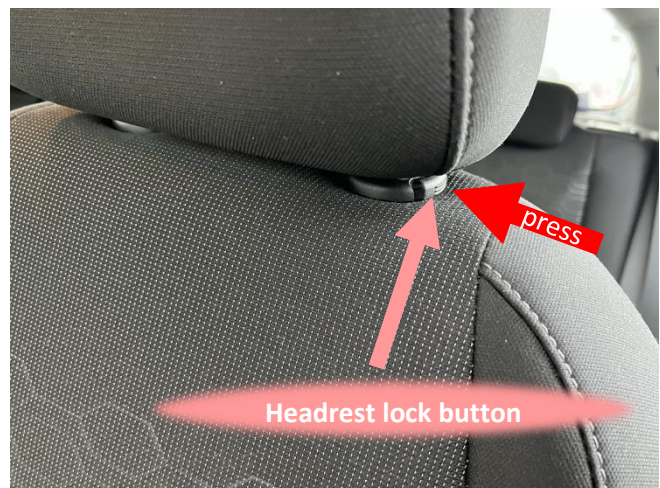

SEATBELT

Fasten your seat belt even before starting the engine. You can adjust the height of the seat belt so that the seat belt does not touch your neck. Fasten the seat belt carefully so that in the event of an accident you do not fly towards the seat belt.

ADJUSTING THE STEERING WHEEL

Adjust the steering wheel so that you also reach the top of the steering wheel. Also, make sure you can see the instrument cluster. Unlock the steering wheel adjustment by pulling the lever all the way down. You can then adjust the steering wheel. When the steering wheel is in the right position, raise the locking lever back up.



MIRRORS

You can adjust the side mirrors when you first switch on the power. Select which mirror you want to adjust by pressing the letter (L) left or (R) right. Now you can adjust the mirror (MIRROR) with the adjustment panel.

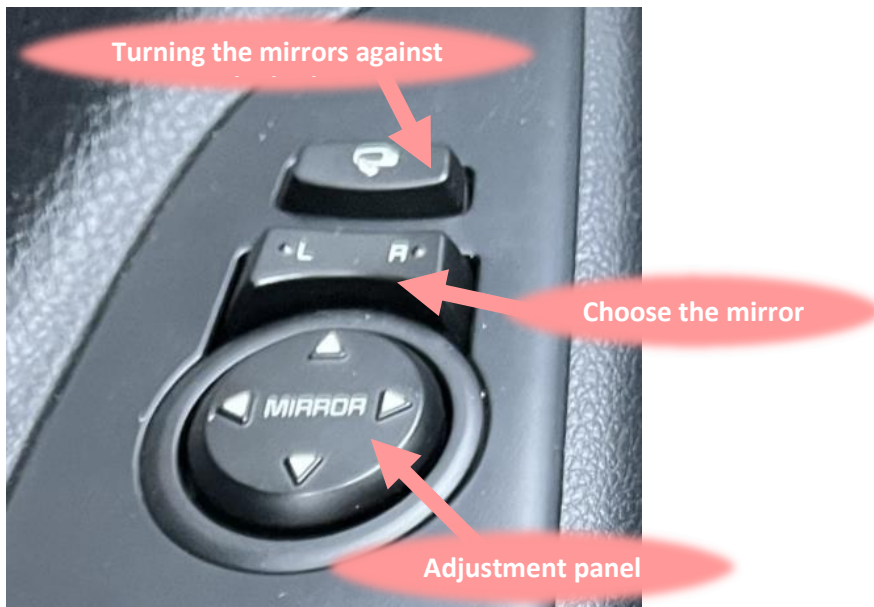

You can adjust the rearview mirror by turning the mirror. Avoid touching the surface of the mirror to avoid fingerprints. Below the mirror, a reversible lever for the night position.

INFO CLUSTER / GAUGE

In the middle of the Kia Rio's instrument panel is an info display (B). You can choose, for example, the driving speed to display it. However, the speedometer (C) is always visible on the right side of the instrument cluster. The tachometer (A) shows the operation of the engine. Normally the rpm is around 1000 rpm, but when you accelerate the engine revs increase. When the engine is warm, the temperature settles to about 90 degrees. You can see the remaining distance at the top of the info screen and can monitor the fuel situation from the fuel gauge.

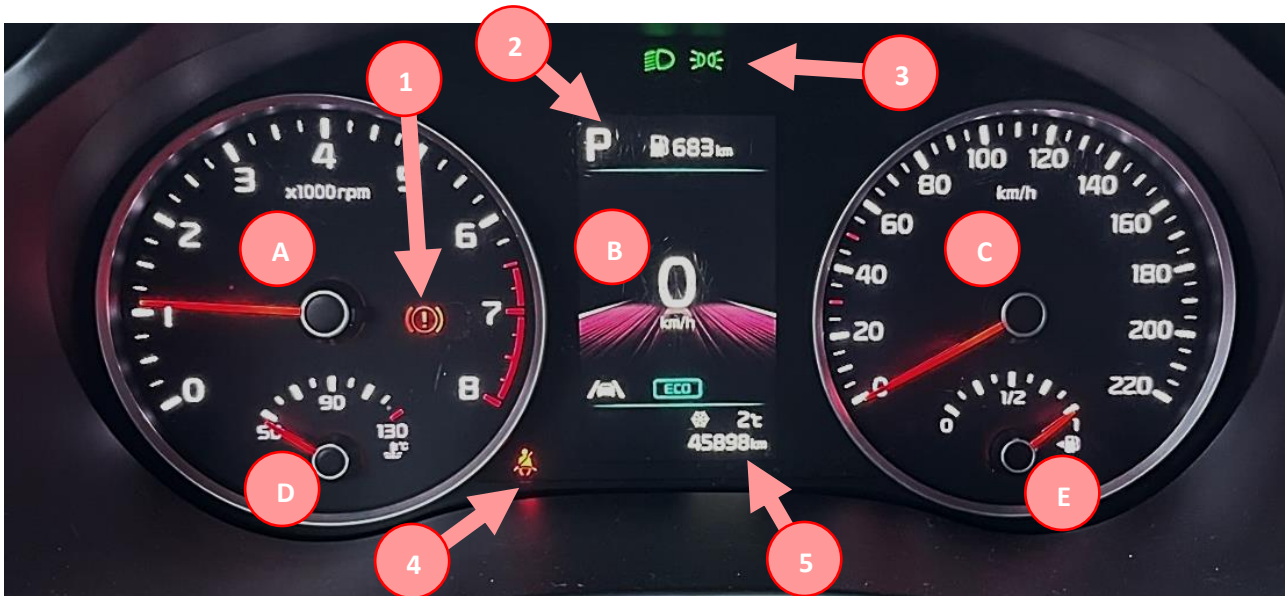

- | | |
|--------------------------|------------------------------------|
| A. Tachometer | 1. Parking brake warning light |
| B. Info (board computer) | 2. Selected gear |
| C. Speedometer | 3. Driving light and parking light |
| D. Temperature of engine | 4. Driver's seat belt |
| E. Fuel gauge | 5. Odometer |

Before driving, make sure that the parking brake warning light (1) is not on. You can see the selected gear (2) in the top left corner of the info screen. The driving light warning lights (3) are visible at the top of the instrument panel. The driver's seat belt warning light can be found in the instrument panel, but the passenger and rear seat belt warning lights can be found in the center console. Check that the doors are closed.



HEATING AND AIR CONDITIONING

Kia Rio has automatic air conditioning. By selecting the appropriate temperature and pressing the AUTO (A) button if necessary, the temperature remains constant and the car automatically adjusts the air direction and fan speed to suit. You can also choose the fan speed to suit yourself (B) with the roller. You should keep the fan on at least 2 - 3 speed so that the car's windows don't fog up. With the button (E) you can choose the direction of the air up to the windshield, in the middle or down to the footwell.



- A) Temperature adjustment (button in the middle for automatic operation)
- B) Fan speed (button A/C air conditioning in the middle)
- C) Windshield defrosting
- D) Shutdown
- E) Air direction selector
- F) Indoor air circulation
- G) Rear window heater (also heating side mirrors)

If the windows fog up heavily, switch on the windshield defroster (C). The rear window heater removes frost from the rear window and also heats the side mirrors.

LIGHTS AND INDICATORS

The light switch is at the end of the blinker. Turn the headlights on by flipping the switch. With automatic lights, the rear lights are not always on. By lifting the blinker upwards, the blinker switches to the right, and by pressing down, the blinker switches to the left. The blinker turns off automatically when you steer. The fog light switch is in the middle of the mustache. By pressing the fog light switch once, the fog light turns on, and with a second press, the fog light turns off.



HAZARD INDICATOR / WARNIGN INDICATOR

The emergency flasher switch is in the middle of the dashboard. By pressing the switch, all the car's blinkers turn on and flash. You should turn on the emergency flasher if you have to stop unexpectedly in a dangerous place. You can also use your hazard lights to warn other road users.



WIPERS AND WASHING

The wipers for the windshield and rear window are on the right side of the steering wheel. By raising the mustache upwards, you make the wipers wipe at a higher speed. By pressing down, the speed of the wipers slows down. You can wash the windshield by pulling the mustache towards you. By pushing towards the instrument panel, you can wash the rear window.

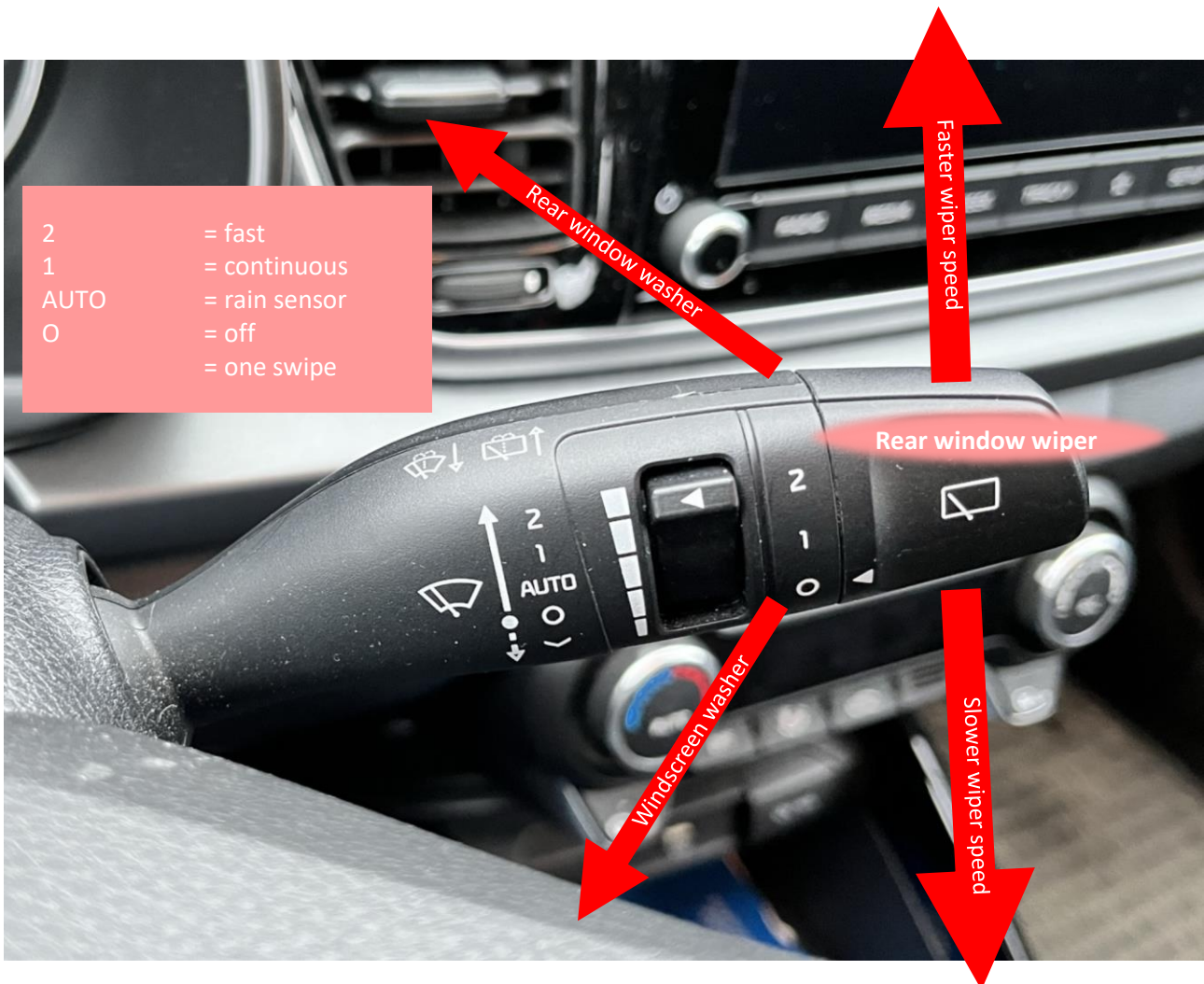

The rear window wiper has two speeds:

- 1 = wiping with pause
- 2 = continuous wiping

CONTROL BUTTONS 1

In front of the gear selector are the switches for the seat heaters (A). The first press starts the heater. With the second press, you can reduce the heating power and with the third press, the heating turns off. Steering wheel heating (B). Reversing radar shutdown (C). With the driving mode selection (D), you can select ECO, NORMAL or SPORT as the driving setting.

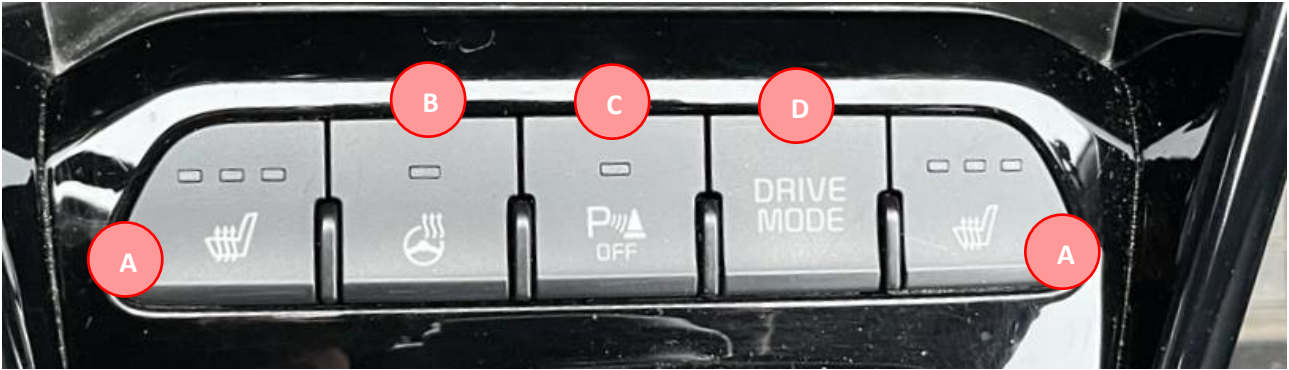

CONTROL BUTTONS 2

On the left side of the steering wheel is the headlight height adjustment roller (A). You can adjust the brightness of the instrument panel to be brighter or dimmer (B) with the switch. When the engine's StartStop function stops, you can turn it off with the switch (C). (D) TCS traction control disengagement. Tire air pressure sensor calibration.

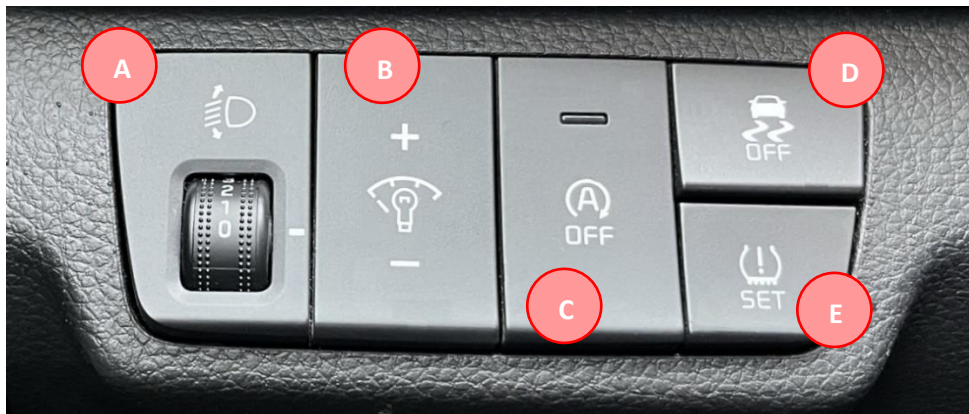

POWER WINDOWS



STEERING WHEEL BUTTONS

On the left side of the steering wheel are the switches for the audio system and the phone. On the right side are the on-board computer, cruise control and lane departure warning switches. It is recommended to switch off the lane departure warning in winter, when the road markings are covered with snow. Hold the button down for at least 4 seconds to turn off lane departure warning.



TOUCH SCREEN

You can see the image of the reversing camera on the touch screen. If you have an iPhone or Android phone that supports the Android Auto system, you can connect the phone to the car screen and get the navigation working. HERE WeGo navigation is a free app and it shows the speed limits in the area. However, there may be errors in the program's data, and especially in road work areas, it indicates an incorrect speed limit.



ENGINE

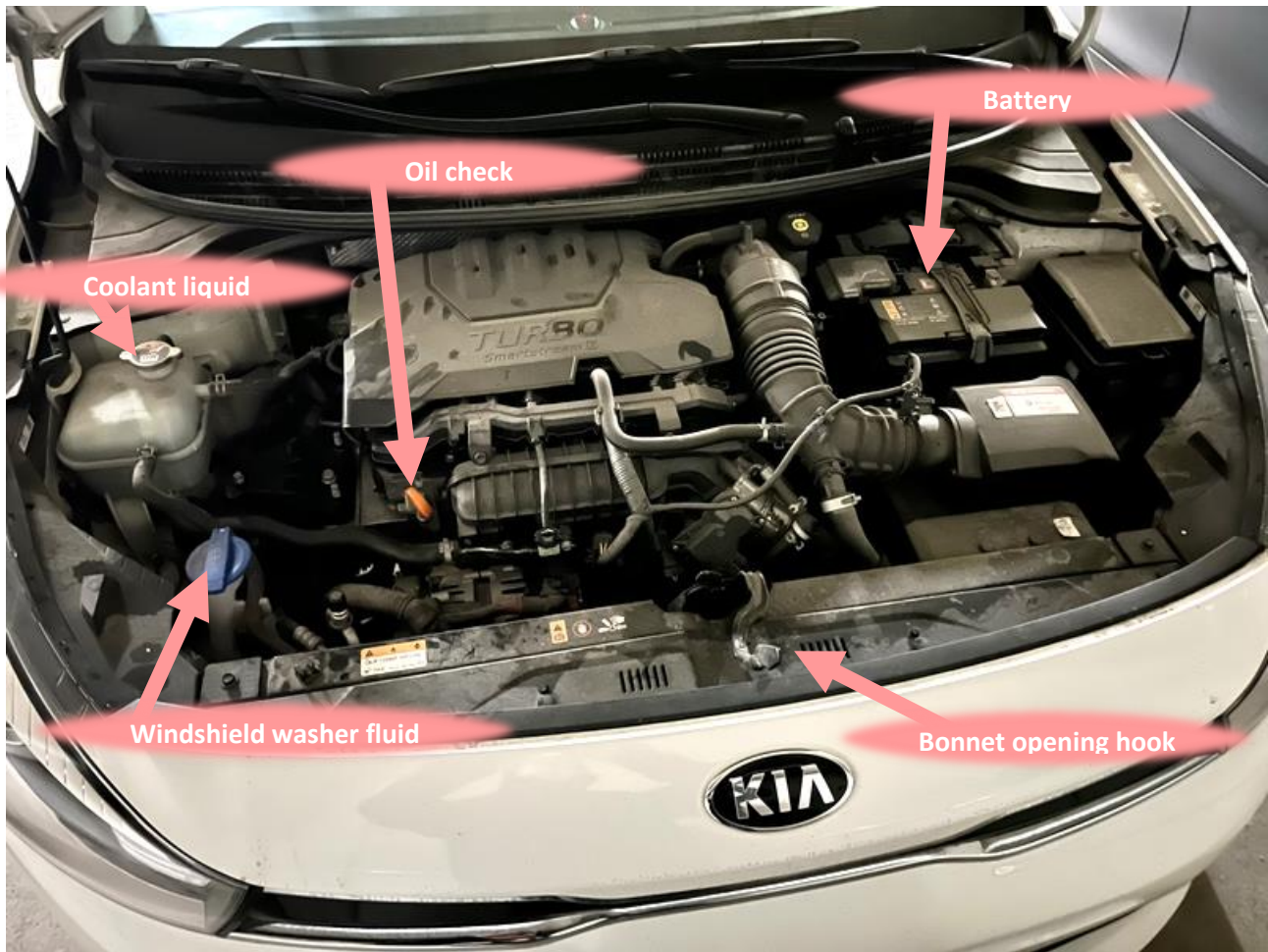

The oil check dipstick is on top of the engine. Clean the dipstick before checking the oil level.



ENGINE

First unlock the hood from inside the car from the driver's footwell. Next, turn the hood opening hook to the left and lift the hood up. Place the hood support upright.

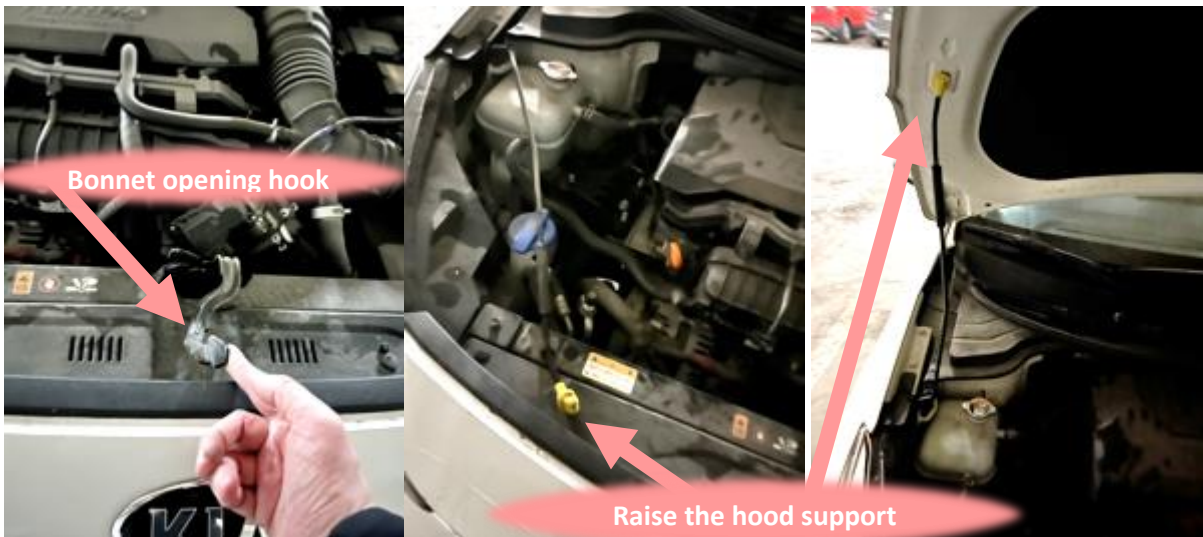



AUTOKOULU **Eco**
Eco